

Installation Steps:

- Insert the provided SD card into the Sd card slot, as shown below. Make sure the yellow SD lock is set in the "unlocked position"

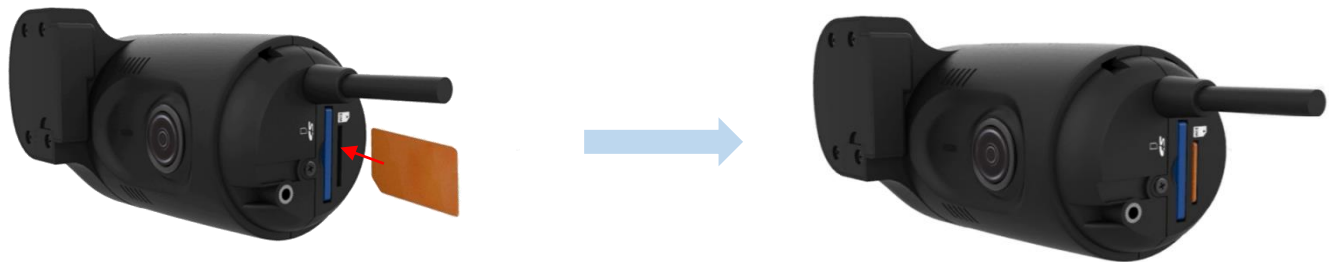

- Then insert the provided Sim card into the second, smaller slot as seen below



- After inserting the SD & SIM cards, attach the side cover plate as seen below. Use the provided torx screw & key to secure the side cover plate to the VT2.2:



- Adjust the bracket by unscrewing the angle bracket lock and removing it. Then you can slide out the bracket and rotate it to the desired angle (use the windshield as a guide to determine the angle (see the image in step F). The bracket can be adjusted up or down based on specific slope of the vehicle's windshield:



- Place the angle lock back into the bracket and secure with the provided screw. Then attach the provided 3M adhesive pad to the VT2.2 bracket and press firmly as shown below:

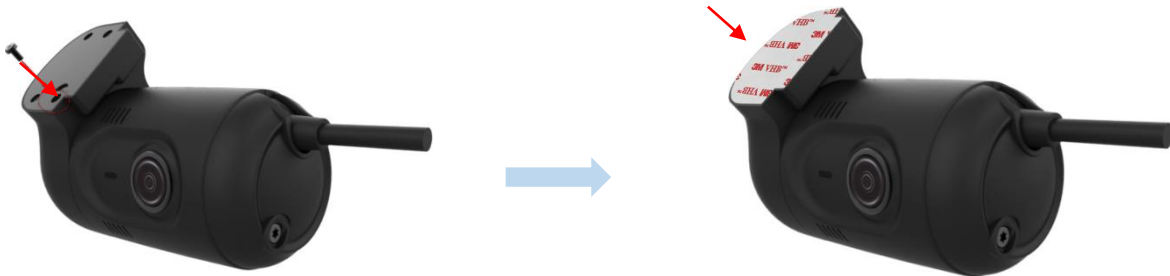

- Secure the VT2.2 to the windscreen behind the rear view mirror, below the AS1 line. The camera lens should be as high on the windshield as possible, but still within the windshield wiper zone.



IMPORTANT: Make sure that the glass is clean and dry before attaching. Hold the camera in position with firm pressure for 30 seconds. The glass temperature should not be too hot or cold. Please install in moderate temperature (recommended between 50°F ~ 80°F).