

VISIONTRACK



VT2000 INSTALLATION AND CALIBRATION GUIDE

THE UK'S MOST AWARD-WINNING CAMERA TELEMATICS COMPANY



www.visiontrack.com

Overview

The **VT2000** is a full-HD 1080p connected vehicle telematics camera, featuring instant remote cloud upload, live view snapshots, automatic health checking, built-in GPS/GLONASS, designed to deliver high-quality videos of incidents instantly to our data platform.



Key features:

Industry-leading, connected and HD-quality vehicle camera and telematics system



Provides First Notification of Loss (FNOL) alerts

Provides HD images before, during and after an incident



Accurate G-shock sensor measures impact force and driving style

Monitor driver behaviour from anywhere using the VisionTrack IoT platform



Built-in GPS and GLONASS receiver with self-checking notifications



VT2000 Installation:

- 1 Provided is a 3M™ adhesive pad, please attach to the VT2000 bracket. Once attached, press firmly onto the windscreen. (See page 3 for mounting position)

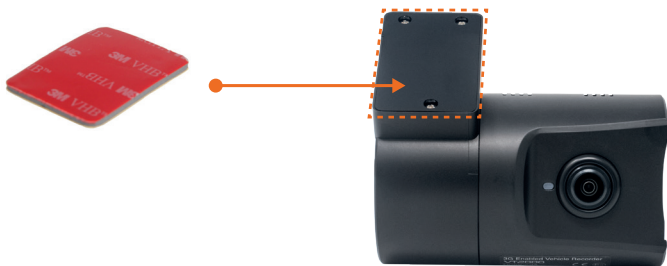

- 2 Adjust the bracket on the VT2000 up or down, depending on the specific angle of your windscreen.





- 3 IMPORTANT: Degrease and clean windscreen before attaching.** After the windscreen is clean, secure the VT2000 behind the rear-view mirror, below the windscreen tint. Place the camera as high on the windscreen as possible, but still within the windscreen wiper area.

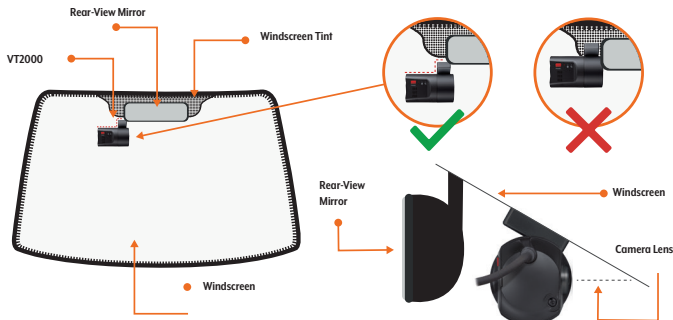

DO NOT APPLY CAMERA TO TINTED WINDSCREEN SURROUND. MUST BE STUCK TO CLEAR GLASS TO AVOID ANY GPS SIGNAL INTERFERENCE.

- 4** Once the VT2000 is secured onto the windscreen, please attach the security seal onto the angle lock, ensuring that the device cannot be tampered with.

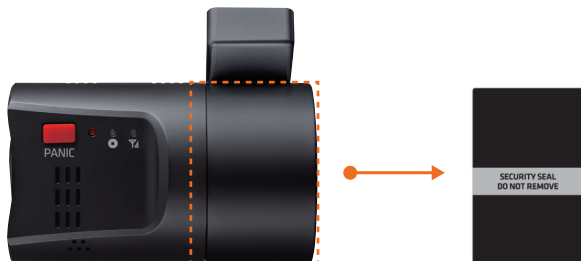

NOTE: IF THE SECURITY SEAL IS REMOVED, THE SEAL WILL DISPLAY 'VOID/OPEN', SUGGESTING THAT THE CAMERA MAY HAVE BEEN TAMPERED WITH.

5 Cable routing for the VT2000 shown below.

This layout keep noise from the device away from the GPS system, but assumes cable layout to the vehicle nearside A Pillar.



RED layout routes noise into the antenna, potentially deteriorates the performance of the GPS

- Noise from device routed in
- Noise from GPS communications routed in
- Noise from vehicle routed in

GREEN layout ideally routes away from the GPS antenna, through the headlining and reduces interference.



VT2000 Calibration:

- 1 On start-up, the **GREEN** light will flash and the **BLUE** light will stay solid, once the camera is operational you will hear an audio beep.

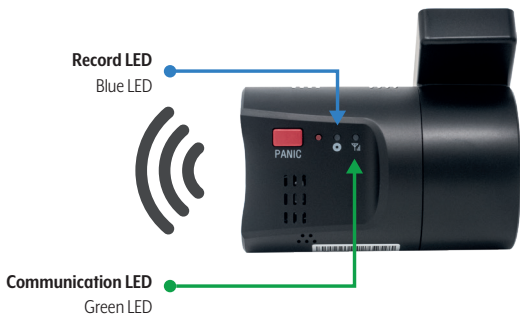

- 2 Park your vehicle on a flat surface and press and hold calibration button for 5 seconds, the camera will beep again.



THE UK'S MOST AWARD-WINNING CAMERA TELEMATICS COMPANY



www.visiontrack.com



VISIONTRACK

powered by  AUTONOMISE.AI

VT2000 INSTALLATION & CALIBRATION GUIDE

t+44 (0) 1246 225 745 | **s** support.visiontrack.com | **w** visiontrack.com