

VISIONTRACK

THE NEXT GENERATION OF TELEMATICS
AND INTEGRATED CAMERA SOLUTIONS

VT1000

INSTALLATION GUIDE



THE UK'S MOST **AWARD-WINNING CAMERA TELEMATICS** COMPANY



www.visiontrack.com

Overview

The **VT1000** is a full HD 1080p vehicle camera, giving you a comprehensive view of any incident and providing court-admissible evidence. The camera features a super-wide-angle lens, G-shock sensor and lockable, tamper-proof SD-card cover, and can also be integrated with third-party telematics systems.

Key Features:

- Full HD 1080p/720p
- High-quality super-wide pillar-to-pillar viewing angle 3-megapixel CMOS sensor
- Adjustable recording rate from 1 FPS to 30 FPS (real-time)
- Trigger output for integration with telematics devices
- Fully lockable case for seamless finish
- 45(L) x 50(H) x 100(W)mm



VisionTrack Software:



What's in the box:



1. VT1000 Vehicle Recorder



2. VT1000 Power Kit Cable



3. 3M™ Pad (x2)



4. Lockable Case Keys (x1 set)



5. Angle Stopper and Screws (x1)

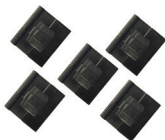

6. Wire Splice Clips (x5)

VT1000 Installation:

1. Make sure vehicle is parked on a flat level surface.
2. Turn off the engine before installing the VT1000.
3. Adjust camera view. Make sure the lens has an unobstructed view. Check from outside the vehicle to check the camera angle, you can adjust the angle via the bracket teeth.



4. Attach the VT1000 using the provided double sided 3M tape. The surface must be clean and dry before you install. We recommended to install the product behind the rear view mirror on the front windshield.

NOTE: THE 3M ADHESIVE TAPE WILL NOT STICK WELL WITH DUST OR OIL, ETC. PLEASE MAKE SURE THE SURFACE IS CLEAN BEFORE APPLYING.





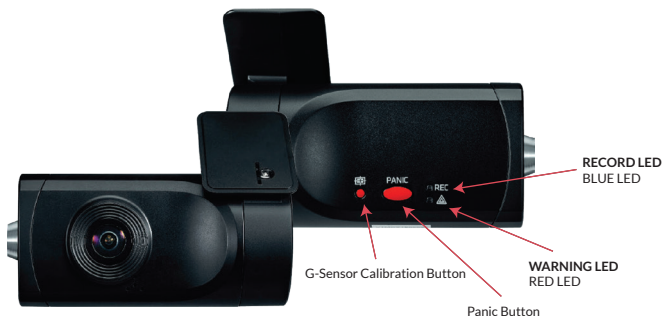

5. Arrange the power cord neatly alongside of the windshield and door pillar trim.

The VT1000 requires a continuous 12/24volt power source from the vehicle. The cable supplied will allow you to hard wire the VT1000 unit to the fuse box of your vehicle.

6. Please following wiring diagram for correct wiring setup.
7. Once wiring is complete, start vehicle engine to confirm installation is complete and camera is functioning.

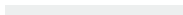

Power Cable* Wiring Diagram

-  **Black** (Ground)
-  **Red** (Ignition Power) (Permanent power not recommended)
-  **White** (External Panic Button+)
-  **Blue** (External panic button -)
-  **Green** (Alarm out1), Low(0V) to High (5V) 2seconds
-  **Yellow** (Alarm out2), Low(0V) to High (5V) 2seconds

BLUE LED (RECORD)

The blue LED shows the power is on.

During the continuous recording: blue LED will be on 4seconds and off 1second.

During the event recording: blue LED will be on 0.5 second and off 0.5 second.

During the Parking mode: blue LED will be on 8seconds and off 1second.

RED LED (Warning LED)

The red LED will be turned on when system failure.

Buzzer

A 'Beep' sound will occur when event recording starts (this can be turned off, if required by uncheck "Event Beep" at Settings)

Status	BLUE LED	RED LED	BUZZER
Booting	on	on	off
Upgrade	heartbeat	heartbeat	off
Continuous recording	4sec / 1sec	off	off
Triggered Event recording	0.5sec on/off	off	100msec on
SD fault	off	0.5 sec on/off	off
System fault	on	on	off
SD unmount	on	off	0.1sec on 2 times
SD reset	on	off	0.1sec on 2 times
SD Full	off	2sec / 2sec	off
G-Sensor calibration	-	-	0.1sec on 1 time
Parking Mode	8sec / 1sec	off	off
Power off	off	off	off

VT1000 Calibration:

1. On start-up, press the **RED** calibration button once.



2. Calibration is complete once a beep sound is heard.

THE UK'S MOST AWARD-WINNING CAMERA TELEMATICS COMPANY



 **VISIONTRACK**

www.visiontrack.com

VT1000 INSTALLATION GUIDE

 **VISIONTRACK**

2 Chapman Way
High Brooms Industrial Estate
Tunbridge Wells
Kent
TN2 3EF



Visiontrack Official Website